



PRODUCT SPECIFICATION

※ Features:

- ◇ More Energy Efficient than incandescent and most halogen lamps
- ◇ Long operating life
- ◇ Low forward voltage operated
- ◇ Instant light (less than 100ns)
- ◇ No UV

※ Outline Dimensions

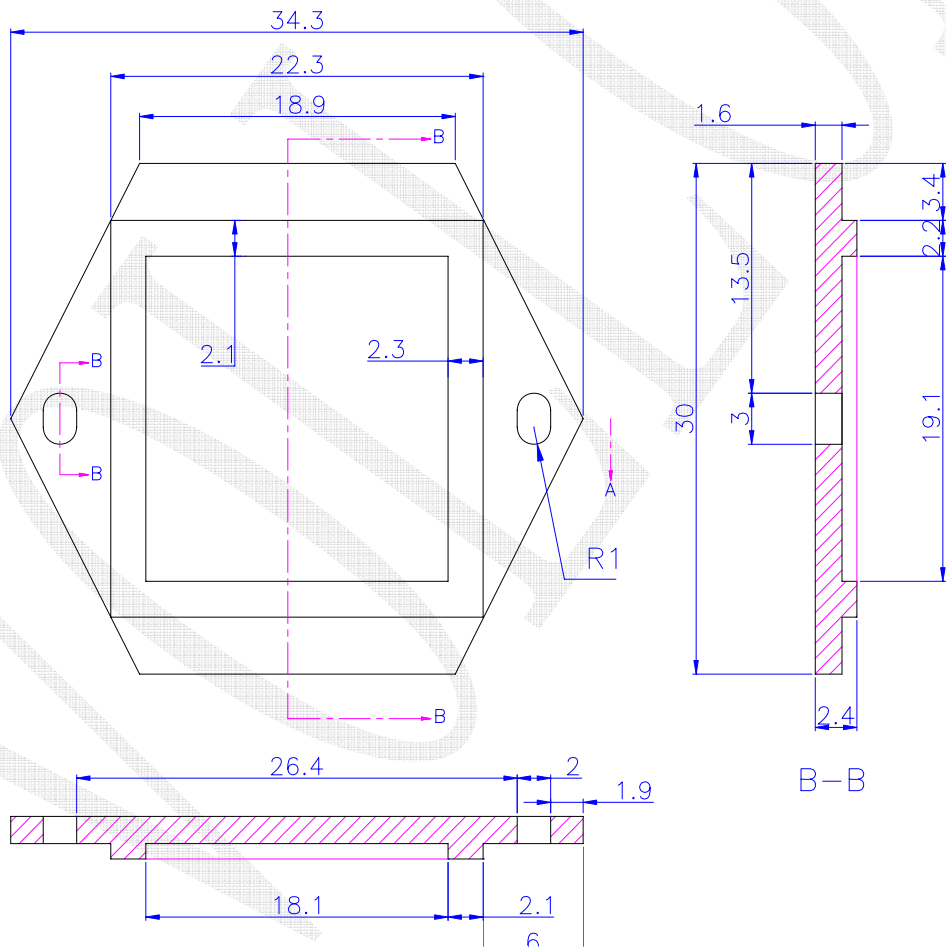

| | | | |
|----------------------------|---------------------|-----------------------------|-------------|
| REVISION | ECN/ECR INFORMATION | TITLE: | SHEET No. |
| A | ECN NO. DATE | 3W White Hexagon Planar LED | 1 of 3 |
| P/N#: VL-H02W5500380H35 | CREATED By | CHECKED By | APPROVED BY |



PRODUCT SPECIFICATION

※ Absolute Maximum Ratings at Ta=25°C:

| Parameter | Symbol | Maximum | Unit |
|--|----------|------------------|------|
| Power Dissipation | Pd | 3 | W |
| Peak Forward Current (1/10 Duty Cycle, 0.1ms Pulse Width) | IF(peak) | 300 | mA |
| Continuous Forward Current | IF | 240 | mA |
| LED junction temperature | JT | 120 | °C |
| Reverse Voltage | VR | 5 | V |
| Operating temperature range | Topr | -20°C to + 80°C | |
| Storage Temperature Range | Tstg | -30°C to + 100°C | |

※ Electrical/Optical Characteristics at Ta=25°C:

| Parameter | Symbol | Test Condition | Min. | Typ. | Max. | Unit |
|---|----------------|----------------|------|------|------|------|
| Luminous flux | ϕ | IF=240mA | 180 | 200 | 220 | Lm |
| Viewing Angle | 2 θ 1/2 | IF=240mA | | 170 | | deg |
| Forward Voltage | V _F | IF=240mA | | 13.5 | 16 | V |
| Reverse Current | I _R | VR=5V | | | 100 | uA |
| Color Rendering Index Calculation | Spm | X | 0.31 | | 0.35 | |
| | Spm | Y | 0.32 | | 0.37 | |
| Correspondingly | CCT | IF=240mA | 5000 | 5500 | 6500 | K |

| | | | |
|----------------------------|--|---------------------------------------|---------------------|
| REVISION A | ECN/ECR INFORMATION ECN NO. DATE | TITLE: 3W White Hexagon Planar LED | SHEET No. 2 of 3 |
| P/N#: VL-H02W5500380H35 | CREATED By | CHECKED By | APPROVED BY |



PRODUCT SPECIFICATION

※Typical Electrical/Optical Characteristics Curve: (25°C Ambient Temperature Unless Otherwise Noted)

Fig1. Relative Intensity vs. Wavelength

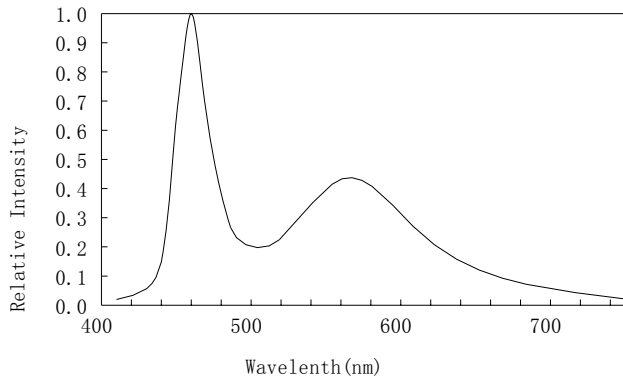

Fig2. Forward Current vs. Forward Voltage

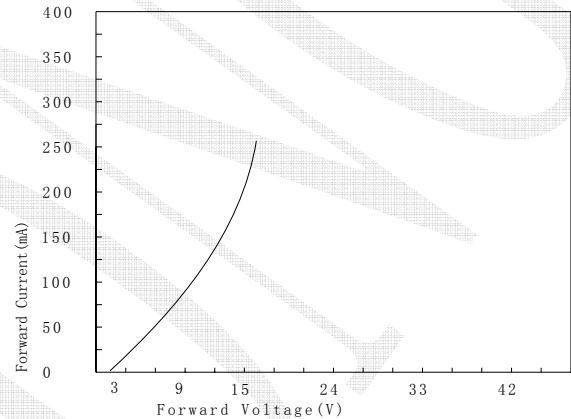

Fig3. Forward Current vs. Relative Intensity

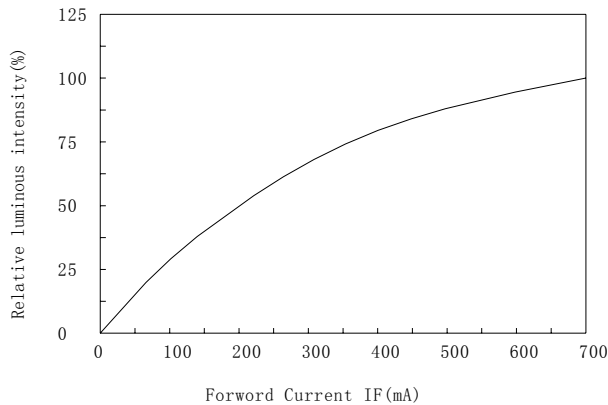
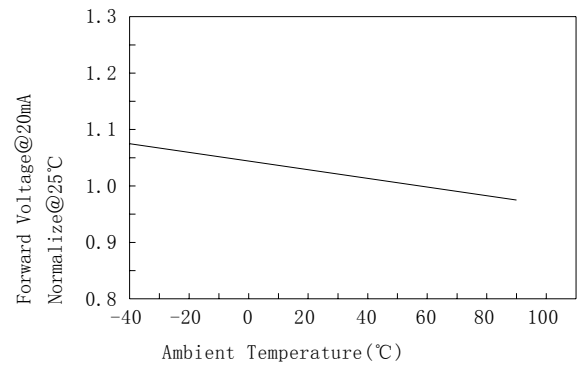

Fig4. Forward Voltage vs. Temperature



※Cautions:

Used this products , your may put the POWER LED lose hot chips and touch the lose hot install or enlarge the lose hot condition , so that when the lighting ,the products can lose hot , make sure that the lighting and long lifespan .

| | | | |
|----------------------------|--|---------------------------------------|---------------------|
| REVISION A | ECN/ECR INFORMATION ECN NO. DATE | TITLE: 3W White Hexagon Planar LED | SHEET No. 3 of 3 |
| P/N#: VL-H02W5500380H35 | CREATED By | CHECKED By | APPROVED BY |